

Illustrated Parts for 9940

WASTE KING

Included Parts

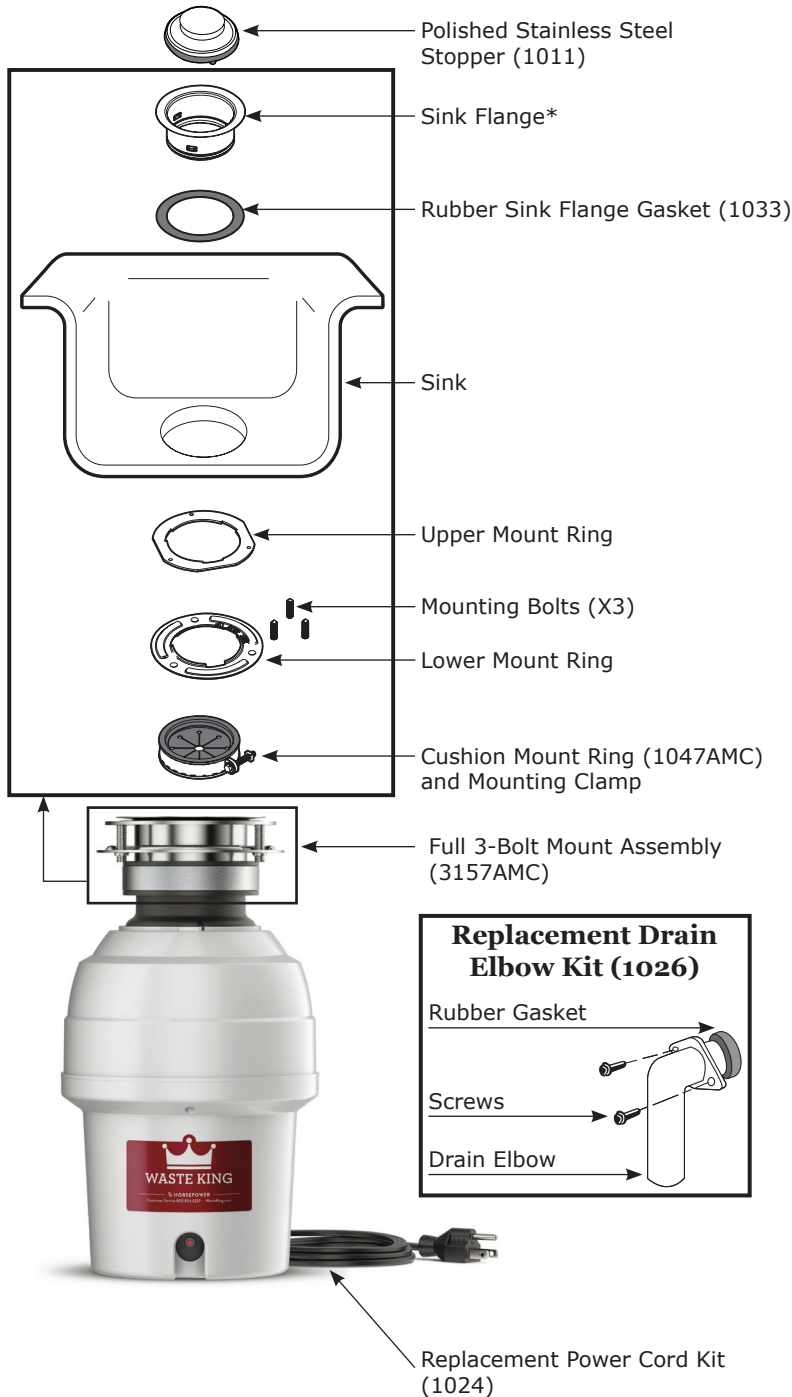

Replacement Drain Elbow Kit (1026)

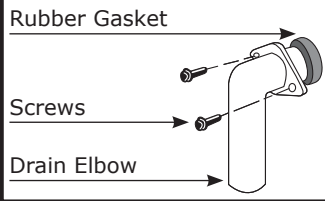

Other Available Accessories



Air Switch Remote Controller

- Installs into existing sink hole (1-1/4") to operate disposer with plunger air switch.
- Perfect application for island counter tops or where electrical switch is unavailable.
- Plug-in: No wiring connections (continuously powered outlet required).

Air Switch Base Unit

Air Switch Remote Controller	ARC-4200
Additional Air Switch Button Finish Options:	
Chrome	AS-4201-CH
Satin Nickel	AS-4201-SN
Polished Brass	AS-4201-BR
White	AS-4201-WH
Almond	AS-4201-AL
Biscuit	AS-4201-BIS



Extended 3-Bolt Sink Flange* (accommodates sinks between 1/2" and 1-3/8")

Polished Stainless Steel	3140AMC
Satin Nickel	3141AMC
Brass	3142AMC



Decorative 3-Bolt Flange and Stopper*

Polished Stainless Steel	3150AMC
Brass	3151AMC
White	3152AMC
Almond	3153AMC
Satin Nickel	3154AMC
Oil Rubbed Bronze	3156AMC

Dishwasher Connector Kit - (connects 1-1/4", 1" and 3/4" outside diameter dishwasher drain hoses to the dishwasher inlet)



1023

Unjamming Wrench



1037

Disposal purchase comes with all Included Parts, Other Available Accessories can be purchased separately

FOR MORE INFORMATION CALL: 1-800-854-3229
WasteKing.com