

Illustrated Parts for 9980

WASTE KING

Included Parts

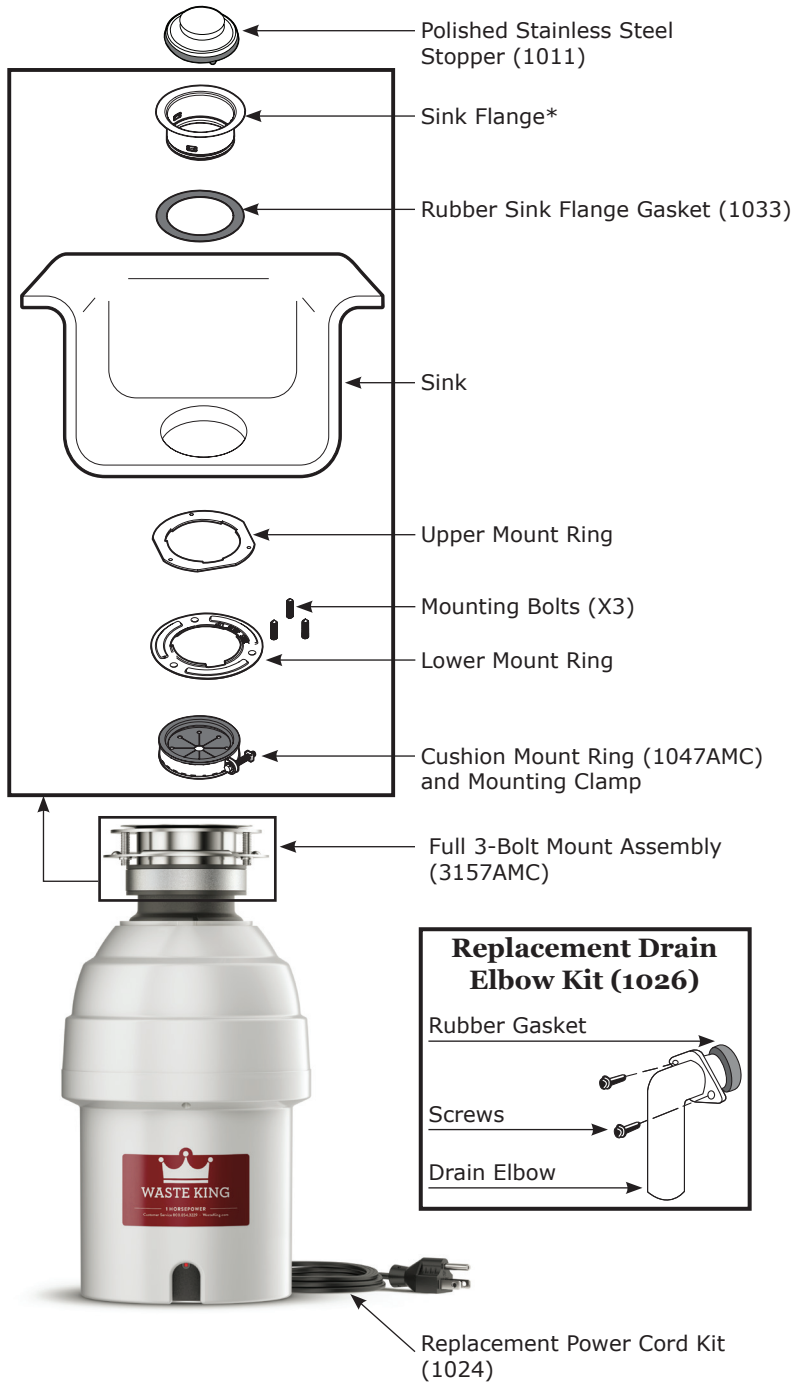

Replacement Drain Elbow Kit (1026)

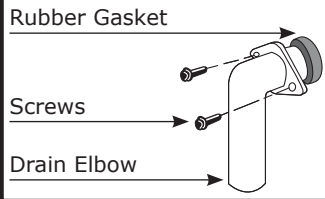

Other Available Accessories



- Air Switch Remote Controller**
- Installs into existing sink hole (1-1/4") to operate disposer with plunger air switch.
 - Perfect application for island counter tops or where electrical switch is unavailable.
 - Plug-in: No wiring connections (continuously powered outlet required).

Air Switch Base Unit	
Air Switch Remote Controller	ARC-4200
Additional Air Switch Button Finish Options:	
Chrome	AS-4201-CH
Satin Nickel	AS-4201-SN
Polished Brass	AS-4201-BR
White	AS-4201-WH
Almond	AS-4201-AL
Biscuit	AS-4201-BIS



Extended 3-Bolt Sink Flange* (accommodates sinks between 1/2" and 1-3/8")	
Polished Stainless Steel	3140AMC
Satin Nickel	3141AMC
Brass	3142AMC



Decorative 3-Bolt Flange and Stopper*	
Polished Stainless Steel	3150AMC
Brass	3151AMC
White	3152AMC
Almond	3153AMC
Satin Nickel	3154AMC
Oil Rubbed Bronze	3156AMC

Dishwasher Connector Kit - (connects 1-1/4", 1" and 3/4" outside diameter dishwasher drain hoses to the dishwasher inlet)

1023

Unjamming Wrench

1037

Disposal purchase comes with all Included Parts, Other Available Accessories can be purchased separately